

NOTE "C" SLOPED ROOF CONSTRUCTION
 19/32" APA RATED SHEATHING PLACED PERPENDICULAR TO SUPPORTING MEMBERS. TOP OF SHEATHING ELEVATION VARIES.

NOTE "D" FLAT ROOF CONSTRUCTION
 23/32" TONGUE-AND-GROOVE APA RATED EXPOSURE 1 SHEATHING PLACED PERPENDICULAR TO SUPPORTING MEMBERS. TOP OF SHEATHING ELEVATION - SEE PLAN.

ROOF FRAMING PLAN
 SCALE: 1/8"=1'-0"

NOTE:
 1. ALL ROOF PITCHES TO BE 7:12, UNLESS NOTED OTHERWISE ON PLAN.

MARK	POST SIZE
P1	2 - 2 x 4
P2	4 x 4
P3	3 - 2 x 4
P4	4 x 6
P5	4 x 8
P6	2 - 2 x 6
P7	3 - 2 x 6
P8	6 x 6
P9	6 x 8
P10	3 1/2" x 3 1/2" PARALLAM
P11	3 1/2" x 5 1/4" PARALLAM
P12	3 1/2" x 7" PARALLAM
P13	5 1/4" x 5 1/4" PARALLAM
P14	5 1/4" x 7" PARALLAM
P15	7" x 7" PARALLAM

POST NOTES:
 1. PROVIDE SIMPSON AC AND ACE POST CAPS AT ALL POSTS NOTED -CO AND -ECC RESPECTIVELY.
 2. PROVIDE SIMPSON CCO AND ECCO COLUMN CAPS AT ALL POSTS NOTED -CO AND -ECC RESPECTIVELY.
 3. ALL BUILT-UP POSTS SHALL BE GLUED AND NAILED WITH 10d COMMON WIRE NAILS PLACED AS FOLLOWS:
 A. ADJACENT NAILS SHALL BE DRIVEN FROM OPPOSITE SIDES OF THE POST.
 B. PLACE NAILS 2 1/2" FROM POST END.
 C. PLACE NAILS AT 8" O.C. ALONG POST.
 D. PROVIDE 2 ROWS OF NAILS 1 1/2" FROM THE EDGE.
 4. AT 5 1/4" PARALLAM POSTS IN 2x6 WALLS, ADD 1/4" PLYWOOD AS REQ'D. TO MATCH THE WALL THICKNESS.
 5. PROVIDE 2 STORY TALL POSTS FOR ALL LOCATIONS NOTED AS -2S AT THE INTERMEDIATE FLOOR OF THE 2 STORES.

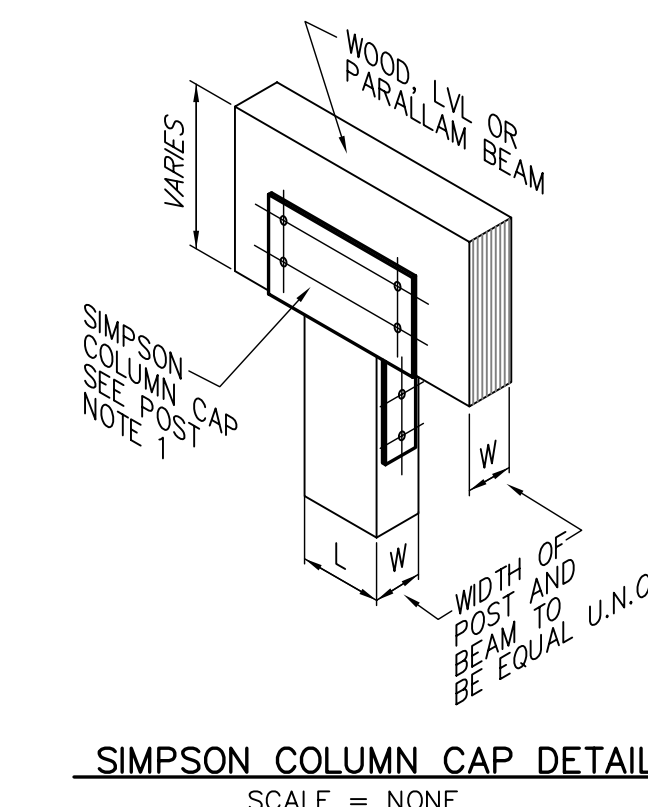

SIMPSON COLUMN CAP DETAIL
 SCALE = NONE
NOTE:
 1. CC CAP SHOWN, CCO, ECC AND ECCO SIMILAR.

WALL STUD SCHEDULE					
FLOOR	EXTERIOR ROOF BEARING WALLS	EXTERIOR BEARING WALLS	INTERIOR BEARING WALLS	CORRIDOR WALLS	PROJECTING MECH. ROOM WALLS ONLY
4TH	2x6 @ 16" O.C.	2x6 @ 16" O.C.	2x6 @ 16" O.C.	2-2x4 @ 16" O.C.	2x4 @ 16" O.C.
3RD	2x6 @ 16" O.C.	2x6 @ 16" O.C.	2x6 @ 16" O.C.	2-2x4 @ 16" O.C.	2x4 @ 16" O.C.
2ND	2x6 @ 16" O.C.	2x6 @ 16" O.C.	2-2x6 @ 16" O.C.	2-2x4 @ 16" O.C.	2x4 @ 16" O.C.
1ST	2x6 @ 16" O.C.	2-2x6 @ 16" O.C.	2-2x6 @ 16" O.C.	2-2x4 @ 16" O.C.	2-2x4 @ 16" O.C.
GROUND	2x6 @ 16" O.C.	2-2x6 @ 16" O.C.	3-2x6 @ 16" O.C.	2-2x4 @ 16" O.C.	2-2x4 @ 16" O.C.

WALL STUD SCHEDULE NOTES:
 1. WALL STUDS SPACED AT 16" O.C. U.N.O.
 2. DOUBLE AND TRIPLE STUDS TO BE FASTENED TOGETHER PER POST NOTE 3.

BEAM SCHEDULE			
MARK	SIZE	MARK	SIZE
B1	2 - 2 x 6	B11	3 - 2 x 6
B2	2 - 2 x 8	B12	3 - 2 x 8
B3	2 - 2 x 10	B13	3 - 2 x 10
B4	2 - 2 x 12	B14	3 - 2 x 12
B5	2 - 1 3/4" x 5 1/2" LVL	B15	3 - 1 3/4" x 5 1/2" LVL
B6	2 - 1 3/4" x 7 1/4" LVL	B16	3 - 1 3/4" x 7 1/4" LVL
B7	3 1/2" x 9 1/2" LVL	B17	5 1/4" x 9 1/2" LVL
B8	3 1/2" x 11 7/8" LVL	B18	5 1/4" x 11 7/8" LVL
B9	3 1/2" x 14" LVL	B19	5 1/4" x 14" LVL
B10	3 1/2" x 16" LVL	B20	5 1/4" x 16" LVL

BEAM NOTES:
 1. FASTEN MULTIPLE PLY BEAMS PER STRICTER REQUIREMENTS OF TYPICAL 2 & 3 PIECE MEMBER FASTENING DETAIL OR MANUFACTURER'S REQUIREMENTS.
 2. SUBSTITUTION OF MULTIPLE PLY BUILT UP BEAMS FOR BEAMS NOTED AS ONE WIDER PIECE IS NOT PERMITTED.
 3. AT 2 - 2x BEAMS IN 2x4 STUD WALLS, ADD 1/2" PLYWOOD SPACERS.
 4. AT 3 - 2x BEAMS IN 2x6 STUD WALLS, ADD 2 - 1/2" PLYWOOD SPACERS.
 5. AT 5 1/4" WIDE BEAMS IN 2x6 STUD WALLS, ADD 1/4" PLYWOOD FILLER.

JOIST AND BEAM HANGER SCHEDULE		
MARK	SIMPSON MODEL	NOTES
U1	LSSU210	TYP. @ SLOPED 2x10 RAFTERS, U.N.O.
U2	LSSU210-2	TYP. @ SLOPED 2-2x10 RAFTERS, U.N.O.
U3	LUS210-2	TYP. @ 2-2x10 AND 2-2x12 BEAMS, U.N.O.
U4	IUS2.37/9.5	TYP. @ 9 1/2" TJI 230, U.N.O.
U5	HU4.75/9	TYP. @ DOUBLE 9 1/2" TJI 230, U.N.O.
U6	IUS3.56/14	TYP. @ 14" TJI 560, U.N.O.
U7	HU414-2	TYP. @ DOUBLE 14" TJI 560, U.N.O.
U8	TH4426	TYP. @ WOOD FLOOR TRUSSES, U.N.O.
U9	HHUS410	TYP. @ B7 AND B8 BEAMS, U.N.O.
U10	LSSU410	TYP. @ SLOPED AND SKEWED B8 BEAMS, U.N.O.
U11	HB3.56/11.88	TYP. @ B8 BEAMS TO STEEL BEAMS, U.N.O.
U12	HHUS5.50/10	TYP. @ B17 BEAMS, U.N.O.
U13	HGUS5.50/12	TYP. @ B18 BEAMS, U.N.O.
U14	HB5.5/11.88	TYP. @ B18 BEAMS TO STEEL BEAMS, U.N.O.
U15	HGUS5.50/14	TYP. @ B19 BEAMS, U.N.O.

HANGER NOTES:
 1. FULLY NAIL ALL HANGERS TO PROVIDE MAXIMUM HANGER CAPACITY.
 2. INSTALL ALL NAILS IN ACCORDANCE WITH MANUFACTURER'S REQUIREMENTS.
 3. INSTALL HANGERS BEFORE INSTALLING SUPPORTED JOISTS OR BEAMS.
 4. ALL HANGERS AND HANGER FASTENERS USED WITH P.T. FRAMING MUST BE ZMAX COATED OR STAINLESS STEEL.
 5. HANGERS FOR ROOF TRUSSES TO BE SIZED AND PROVIDED BY ROOF TRUSS SUPPLIER.

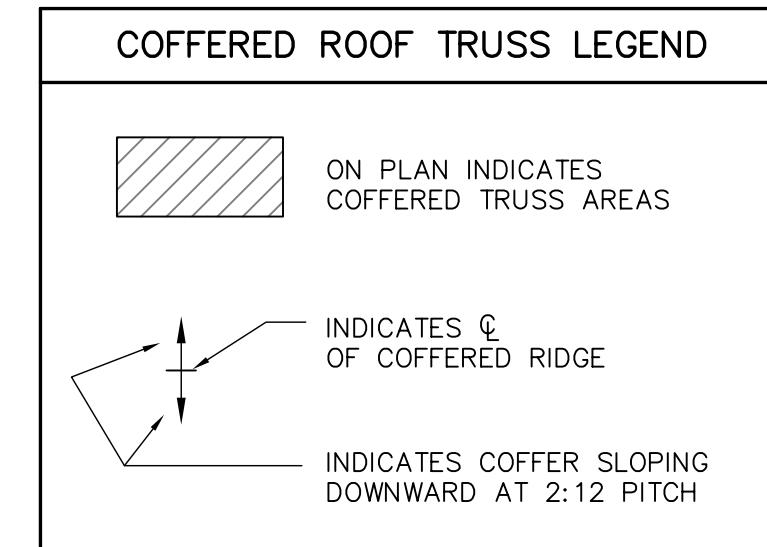

LEGEND	
	ON PLAN INDICATES STRUCTURAL WALLS. SEE WALL STUD SCHEDULE.
	SHEAR WALL: 2x4 OR 2x6 WOOD STUDS @ 16" O.C.
	ON PLAN INDICATES HEADERS. SEE NOTES 2 & 3.
	ON PLAN INDICATES HEADERS WITH OFFSET OPENING(S) ABOVE. SEE NOTES 2, 3 & 4.
	ON PLAN INDICATES A SIMPSON STRONG TIE HANGER OF THE TYPE AND SIZE INDICATED IN THE JOIST AND BEAM HANGER SCHEDULE OR AS SPECIFIED BY THE TRUSS SUPPLIER AT TRUSS CONNECTIONS, U.N.O.
	INDICATES STRUCTURAL WALL TYPE. SEE WALL TYPE SCHEDULE FOR ADDITIONAL INFORMATION. USE WALL TYPE (A) TYP. U.N.O. FOR ALL EXTERIOR WALLS.
	INDICATES HOLDDOWN TYPE AT BASE OF WALL BELOW FLOOR INDICATED. SEE ANCHOR TIE DOWN (ATS) AND TYPICAL DETAILS FOR ADDITIONAL INFO. ATS RUNS INDICATED EXTEND TO ONE OR MORE FLOORS ABOVE PER THE ATS RUN TYPE INDICATED.

WALL LEGEND NOTES:
 1. WALL STUDS, HEADERS, AND TYPES INDICATED OCCUR BELOW THE FRAMING LEVEL SHOWN.
 2. FOR ALL HEADERS, SEE THE HEADER SCHEDULE AND THE OPENING FRAMING DETAILS.
 3. AT BEARING WALLS PROVIDE CRIPPLE STUDS UNDER EACH JAMB AND JACK STUD GROUP BETWEEN THE WALL TOP PLATE AND THE FLOOR SHEATHING ABOVE. CRIPPLE STUDS TO MATCH THE JAMB AND JACK STUD QUANTITY INDICATED FOR THE OPENING ABOVE.
 4. PROVIDE POSTS UNDER THE UPPER FLOOR JAMB AND JACK STUD GROUPS DOWN TO THE HEADER OR THE FLOOR BELOW. SIZE OF POST TO MATCH THE JAMB AND JACK STUD QUANTITY INDICATED FOR THE OPENING ABOVE.

Lynnfield Commons Unknown Street Lynnfield, Massachusetts		ROOF FLOOR FRAMING PLAN	
Russell Scott Steedle & Capone Architects Inc. 18 Brattle Street, Cambridge, Massachusetts 02138 • 617-661-5880 Fax 661-0613		Date: 08/31/07	0762
DM Berg Consultants P.C. Structural Engineers 570 Hillside Ave., Needham, Massachusetts 02464 • 781-444-5158 Fax 444-5157		Date: 09/14/07	S5.1
		Scale: 1/8" = 1'-0"	